

Base Cabinet Specifications Standard and Domestic

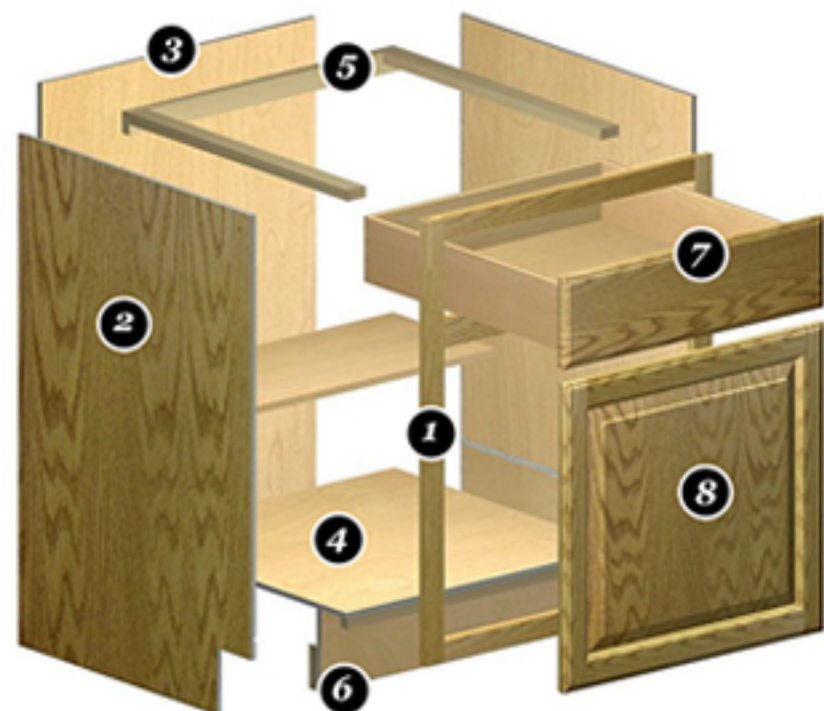

1 Cabinet Fronts

- 3/4" solid wood
- Front stiles are pocket drilled and assembled with 1^{1/4}" screws for rugged durability.

2 Side Panels

- 3/8" particle board
 - DOMESTIC option: 3/8" plywood
 - Vinyl covered on both sides
- Glued and stapled in a 3/8" dado in the cabinet's front frame

3 Back Panels

- 3/8" particle board
 - DOMESTIC option: 3/8" plywood
 - Vinyl covered on inside ONLY
- Glued and nailed in 3/8" dado and stapled to the hang rail and cabinet bottom

4 Floor Panels

- 3/8" particle board
- DOMESTIC option: 3/8" plywood
- Vinyl covered on inside ONLY

5 Hanging Rails

- 3/4" x 1^{1/2}" all wood
- Installed on sides and back.

6 Toe Kick

- 4^{1/2}" high x 4" deep

Shelves

- Fixed 1/2" MDF
- DOMESTIC option: Fixed 1/2" plywood
- Bullnose, foil-covered front edges

7 Drawers

- 1/2" MDF
- NOTE: Cabinets 27" - 36" wide use 1/2" finished solid wood
- DOMESTIC option: 1/2" finished solid wood
 - Bullnose, foil-covered top edges
 - Dovetail construction standard
 - Drawers glide smoothly on self-adjusting ball bearing nylon guides.

8 Doors

- Butt Doors: Standard on 24" - 36" wide cabinets



Wall Cabinet Specifications Standard and Domestic



1 Cabinet Fronts

- 3/4" solid wood
- Front stiles are pocket drilled and assembled with 1^{1/4}" screws for rugged durability

2 Side Panels

- 3/8" particle board
 - DOMESTIC option: 3/8" plywood
 - Vinyl covered on both sides
- Glued and stapled in a 3/8" dado on the cabinet's front frame

3 Back Panels

- 3/8" particle board
 - DOMESTIC option: 3/8" plywood
 - Vinyl covered on inside ONLY
- Glued and nailed in a 3/8" dado and stapled to cabinet top and bottom

4 Top and Floor Panels

- 3/8" particle board
- DOMESTIC option: 3/8" plywood
- Vinyl covered on inside ONLY

5 Backer Rails

- Particle board
 - DOMESTIC option: plywood
- Installed at both the top and bottom of the cabinet

6 Shelves

- Adjustable 1/2" MDF
- DOMESTIC option: Adjustable 1/2" plywood
- Bullnose, foil-covered front edges
- Shelves are held in place with self-locking clips on the sides and center stile (if applicable)

7 Doors

- Butt Doors: Standard on 24" - 36" wide cabinets

Finish

All cabinet front and door surfaces receive stain and a catalyzed clear or a catalyzed paint finish. Our finish provides a deep, rich wood tone that is resistant to household chemicals, water, food stains and mild acids.

Hinges

Hidden, self-closing adjustable hinge

Finish

All cabinet front and door surfaces receive stain and a catalyzed clear or a catalyzed paint finish. Our finish provides a deep, rich wood tone that is resistant to household chemicals, water, food stains and mild acids.

Hinges

Hidden, self-closing adjustable hinge